

LAMPIRAN

Lampiran 1
Biodata Penulis

Nama : Farhan Hikmahtullah Ramadhan
Tempat/Tanggal lahir : Cilacap, 11 Desember 2000
Alamat : Jalan Jawa RT 01 RW 04 Kelurahan Gunungsimping,
Kecamatan Cilacap Tengah, Kabupaten Cilacap, Provinsi
Jawa Tengah, Kode pos 53224
Email : farhan.hikmatulah@gmail.com
Telepon/HP : 088980869822
Motto : “Hidup bukan saling mendahului, bermimpilah sendiri-
sendiri.” ~ Hindia
Riwayat Pendidikan : 1. SDN 02 Gunungsimping Tahun 2006 – 2013
2. SMP Negeri 4 Cilacap Tahun 2013 – 2016
3. SMK Negeri 2 Cilacap Tahun 2016 – 2019
4. Politeknik Negeri Cilacap Tahun 2019 – 2023

Lampiran 2

Software GRBL Control

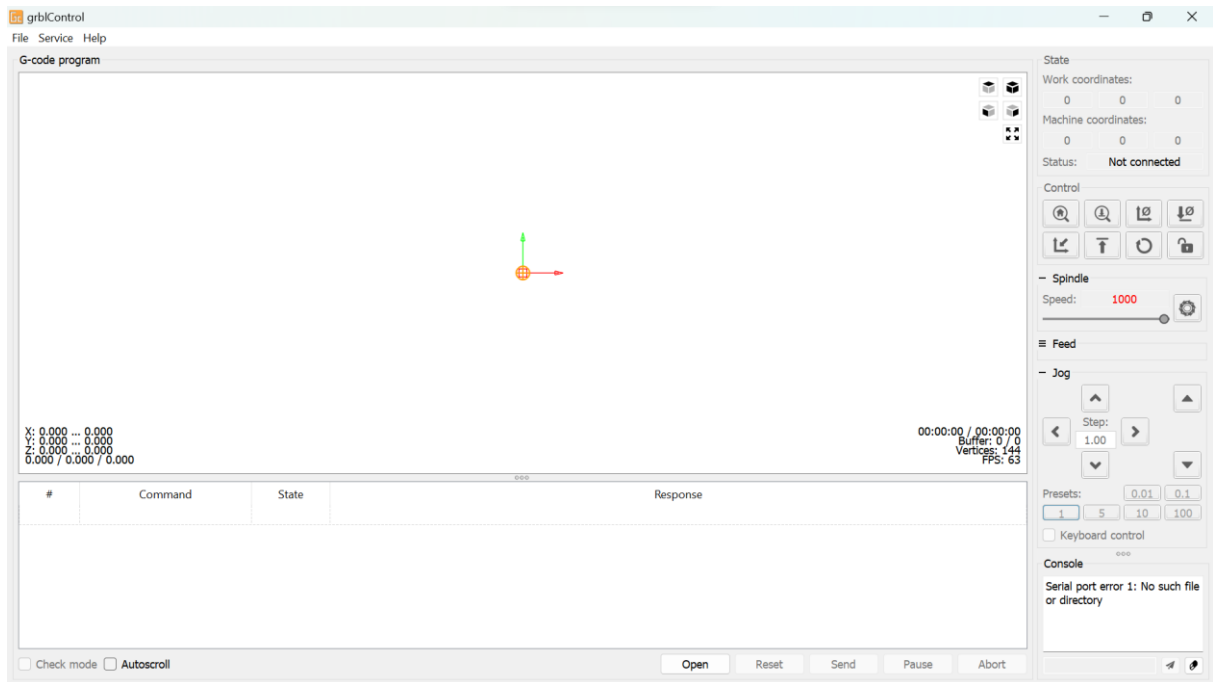

Lampiran 3

Software Engraver Master

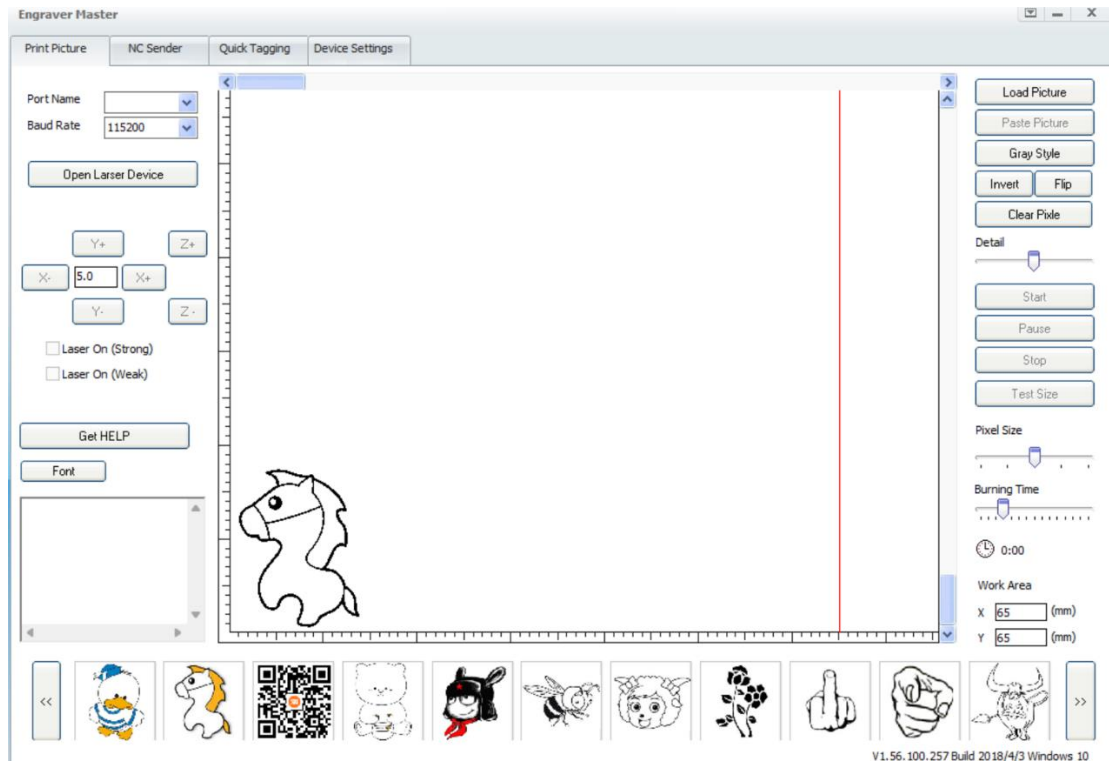

Lampiran 4

Software Arduino

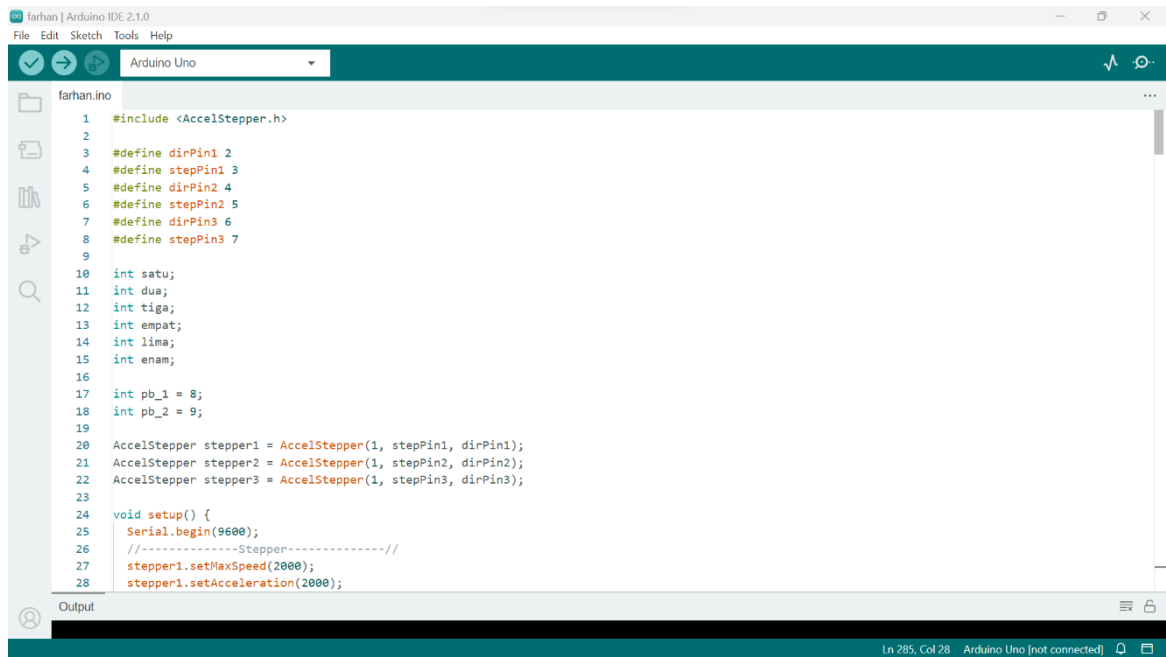

```
1 #include <AccelStepper.h>
2
3 #define dirPin1 2
4 #define stepPin1 3
5 #define dirPin2 4
6 #define stepPin2 5
7 #define dirPin3 6
8 #define stepPin3 7
9
10 int satu;
11 int dua;
12 int tiga;
13 int empat;
14 int lima;
15 int enam;
16
17 int pb_1 = 8;
18 int pb_2 = 9;
19
20 AccelStepper stepper1 = AccelStepper(1, stepPin1, dirPin1);
21 AccelStepper stepper2 = AccelStepper(1, stepPin2, dirPin2);
22 AccelStepper stepper3 = AccelStepper(1, stepPin3, dirPin3);
23
24 void setup() {
25   Serial.begin(9600);
26   //-----Stepper-----//
27   stepper1.setMaxSpeed(2000);
28   stepper1.setAcceleration(2000);
```



Output

Ln 285, Col 28 Arduino Uno [not connected]

Lampiran 5
Hasil uji mesin

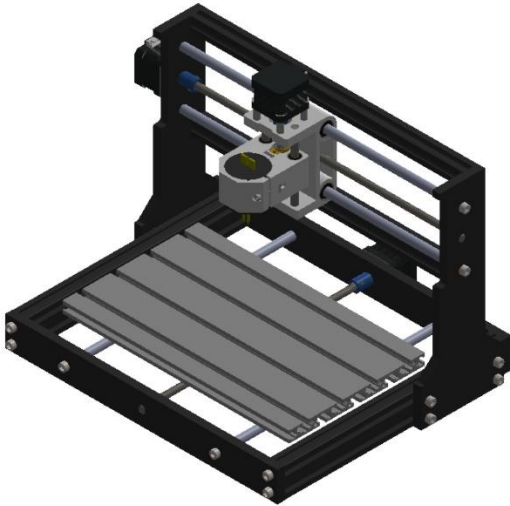

Lampiran 6 Desain Mesin CNC

5		4			3		2		1																							
NO	PERUBAHAN	TANGGAL	NAMA	NO	PERUBAHAN	TANGGAL	NAMA	NO	PERUBAHAN	TANGGAL	NAMA																					
																																
<table border="1" style="width: 100%; border-collapse: collapse;"> <tr> <td style="width: 5%; text-align: center;">></td> <td style="width: 5%; text-align: center;">0</td> <td style="width: 5%; text-align: center;">6</td> <td style="width: 5%; text-align: center;">30</td> <td style="width: 5%; text-align: center;">120</td> <td style="width: 5%; text-align: center;">400</td> <td style="width: 5%; text-align: center;">1000</td> <td rowspan="2" style="text-align: center;">UKURAN LANJUT</td> </tr> <tr> <td style="width: 5%; text-align: center;"><</td> <td style="width: 5%; text-align: center;">6</td> <td style="width: 5%; text-align: center;">30</td> <td style="width: 5%; text-align: center;">120</td> <td style="width: 5%; text-align: center;">400</td> <td style="width: 5%; text-align: center;">1000</td> <td style="width: 5%; text-align: center;">2000</td> </tr> <tr> <td style="text-align: center;">TOL</td> <td style="text-align: center;">±0.1</td> <td style="text-align: center;">±0.2</td> <td style="text-align: center;">±0.3</td> <td style="text-align: center;">±0.5</td> <td style="text-align: center;">±0.8</td> <td style="text-align: center;">±1.2</td> <td></td> </tr> </table>						>	0	6	30	120	400	1000	UKURAN LANJUT	<	6	30	120	400	1000	2000	TOL	±0.1	±0.2	±0.3	±0.5	±0.8	±1.2		NO. ORDER		PROYEKSI	
>	0	6	30	120	400	1000	UKURAN LANJUT																									
<	6	30	120	400	1000	2000																										
TOL	±0.1	±0.2	±0.3	±0.5	±0.8	±1.2																										
MESIN CNC						SKALA		DIGAMBAR		30-05-2023		FARHAN																				
						1:2		DIPERIKSA																								
						DISAHKAN																										
 POLITEKNIK NEGERI CILACAP						FORMAT		MC																								
						A4																										

PERUBAHAN DARI :

DIGANTI DENGAN :

Lampiran 7

Desain bagian

5		4		3		2		1		
NO	PERUBAHAN	TANGGAL	NAMA	NO	PERUBAHAN	TANGGAL	NAMA			
1	LASER DIODA	Plastic	Lihat Detail	-	-	-	-	-	-	
2	PENA LAS SPOT	Tembaga	Lihat Detail	-	-	-	-	-	-	
3	FRAME 1	Aluminium	Lihat Detail	-	-	-	-	-	-	
4	FRAME 1	Aluminium	Lihat Detail	-	-	-	-	-	-	
5	FRAME 2	Bakelit	Lihat Detail	-	-	-	-	-	-	
6	FRAME 2	Bakelit	Lihat Detail	-	-	-	-	-	-	
7	SHAFT GUIDE 1	Alloysteel	Lihat Detail	-	-	-	-	-	-	
8	SHAFT GUIDE 2	Alloysteel	Lihat Detail	-	-	-	-	-	-	
9	BOLT SHAFT	Allowsteel	Lihat Detail	-	-	-	-	-	-	
10	MOTOR STEPPER Z	Mildsteel	Lihat Detail	-	-	-	-	-	-	
11	MOTOR STEPPER X	Mildsteel	Lihat Detail	-	-	-	-	-	-	
No	Nama Bagian	Bahan	Ukuran	Ukuran Kasar	No Id	Keterangan				
>	0	6	30	120	400	1000	UKURAN LANJUT		NO. ORDER	PROYEKSI
<	6	30	120	400	1000	2000				
TOL	±0.1	±0.2	±0.3	±0.5	±0.8	±1.2				
NAMA :							SKALA	DIGAMBAR	30-05-2023	FARHAN
MESIN CNC							1:2	DIPERIKSA		
								DISAHKAN		
NO. ASSY. :							FORMAT	SWB		
POLITEKNIK NEGERI CILACAP							A4			

PERUBAHAN DARI :

DIGANTI DENGAN :

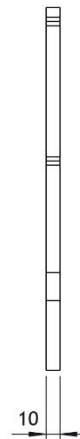
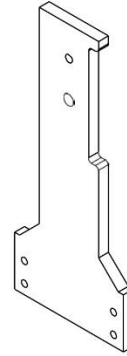
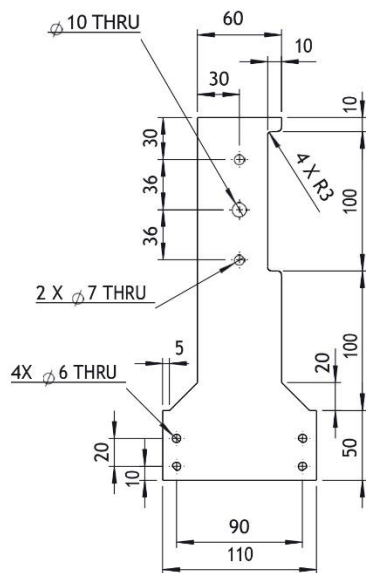

JML	NAMA BAGIAN					BAHAN	UKURAN JADI	UKURAN KASAR	NO. ID	KETERANGAN	
>	0	6	30	120	400	1000	Pengerjaan Lanjut	NO. ORDER	PROYEKSI		
<	6	30	120	400	1000	2000					
TOL	±0.1	±0.2	±0.3	±0.5	±0.8	±1.2					
FRAME 1								SKALA	DIGAMBAR	30-05-2023	FARHAN
								1:4	DIPERIKSA		
									DISAHKAN		
POLITEKNIK NEGERI CILACAP								FORMAT	NO. GAMBAR		
								A4	SWB-08		

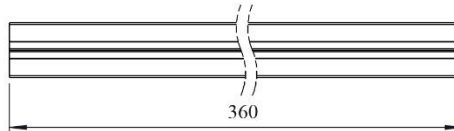
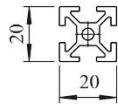
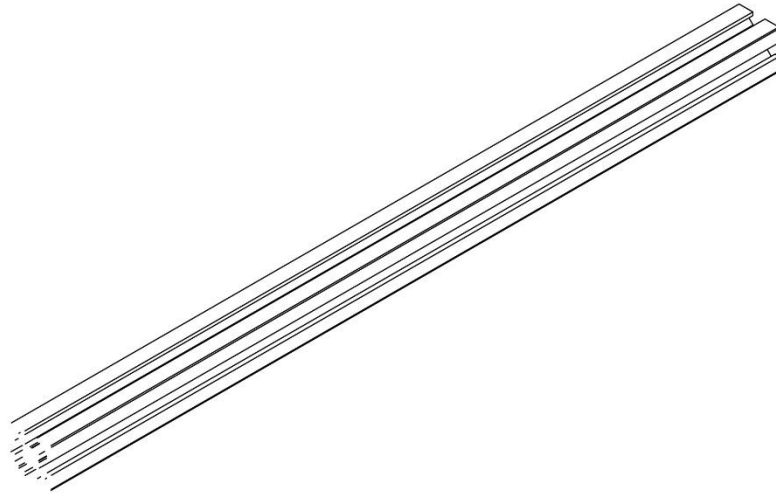

JML	NAMA BAGIAN						BAHAN	UKURAN JADI	UKURAN KASAR	NO. ID	KETERANGAN	
>	0	6	30	120	400	1000	Pengerjaan Lanjut	NO. ORDER	PROYEKSI			
<	6	30	120	400	1000	2000						
TOL	±0.1	±0.2	±0.3	±0.5	±0.8	±1.2						
FRAME 2									SKALA	DIGAMBAR	30-05-2023	FARHAN
									1:2	DIPERIKSA		
										DISAHKAN		
POLITEKNIK NEGERI CILACAP									FORMAT	NO. GAMBAR		
									A4	SWB-09		

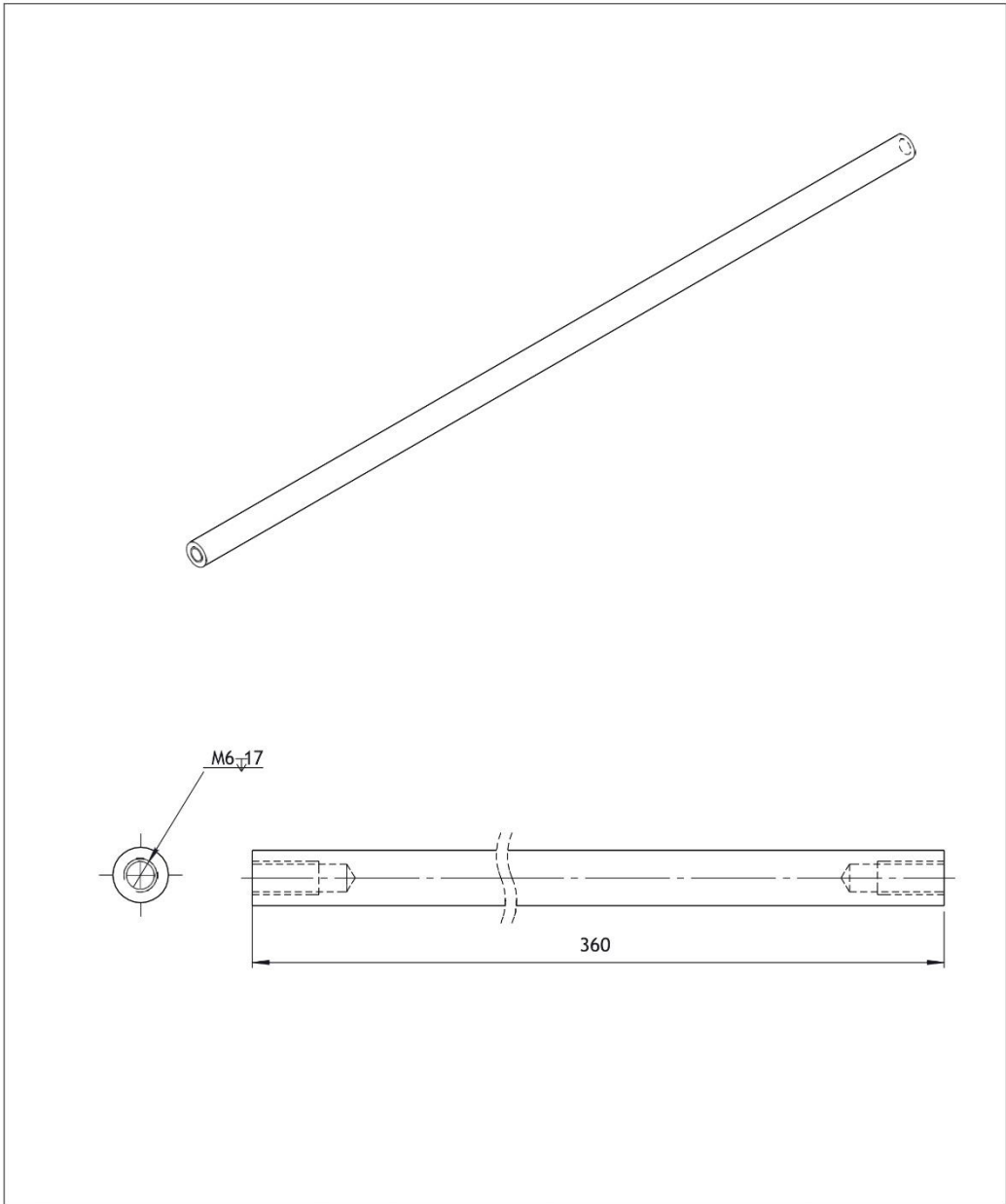

JML	NAMA BAGIAN						BAHAN	UKURAN JADI	UKURAN KASAR	NO. ID	KETERANGAN	
>	0	6	30	120	400	1000	Pengerjaan Lanjut		NO. ORDER	PROYEKSI		
<	6	30	120	400	1000	2000						
TOL	±0.1	±0.2	±0.3	±0.5	±0.8	±1.2						
SHAFT GUIDE									SKALA	DIGAMBAR	30-05-2023	FARHAN
									1:1	DIPERIKSA		
										DISAHKAN		
POLITEKNIK NEGERI CILACAP									FORMAT	NO. GAMBAR		
									A4	SWB-10		

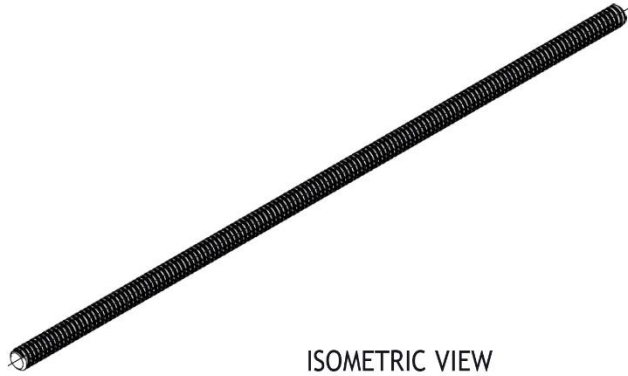

ISOMETRIC VIEW
SCALE 1 : 2

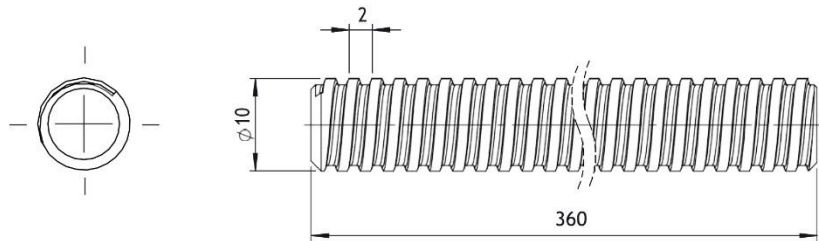

JML	NAMA BAGIAN					BAHAN	UKURAN JADI	UKURAN KASAR	NO. ID	KETERANGAN	
>	0	6	30	120	400	1000	PENGERJAAN LANJUT	NO. ORDER	PROYEKSI		
<	6	30	120	400	1000	2000					
TOL	±0.1	±0.2	±0.3	±0.5	±0.8	±1.2					
BOLT SHAFT								SKALA	DIGAMBAR	30-05-2023	FARHAN
								2:1	DIPERIKSA		
									DISAHKAN		
POLITEKNIK NEGERI CILACAP								FORMAT	NO. GAMBAR		
								A4	SWB-11		